

Window Channel Balance Removal and Installation Guidelines

- Easy Steps to Service Vertical Sliding Windows
- Tips for Identifying and Locating Parts for Replacement
- Instructions on Tuning Windows for Operation

Side Load Sash Removal and Replacement for Non-Tilt Windows

Removal Step 1

Remove sash stop from top of frame jamb. This will expose the formed tabs or take-out clips, which may be pivoted outward as shown in circle.



Removal Step 2

Raise vent until top guide engages take-out clip. Lift slightly and move right or left as far as possible. Removal is then accomplished by swinging the opposite side of the vent inward.

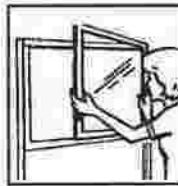
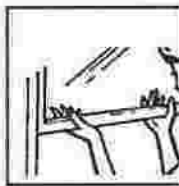

Removal Step 3

Push down on channel balance until top guide is clear of take-out clip. Hold firmly and slowly lift up and away from jamb. Remove terminal clip from square hole in frame jamb.

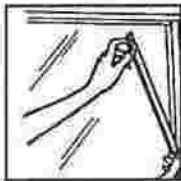
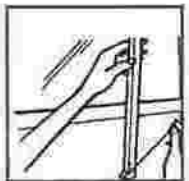

Replacement Step 1



Install new balance assembly by reversing the removal procedure. Insert terminal clip in square hole located in frame jamb. Secure the top guide under the take-out clip. Repeat on other side of window.

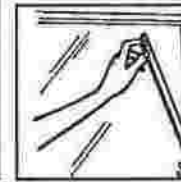

Replacement Step 2

Position right or left side of vent into jamb, above top balance. Swing opposite side into alignment with frame. Lower vent to engage balance. Snap take-out clips back into jamb and re-install sash stops.

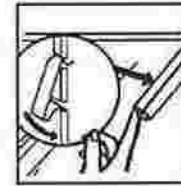
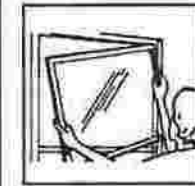

Tips For Replacing Channel Balances

Correct Weights

Use our chart on page F235 to confirm the correct balance was used in the window that is in need of repair. Simply weigh the vent and select the appropriate balances.

Confusing Numbers

Channel Balances are referred to in various ways and numbers. Even though the standard Channel Balances are ordered as 1/2" balances, they are 9/16" by 5/8" in dimension. Lengths also create confusion. A 24" balance is referred to as a 2310, 2320, 2330, etc.

When in doubt.....send samples!

That is the best way we can help you get the right balance.